

BASIC INFORMATION

Straumann ProClean™ Cassette

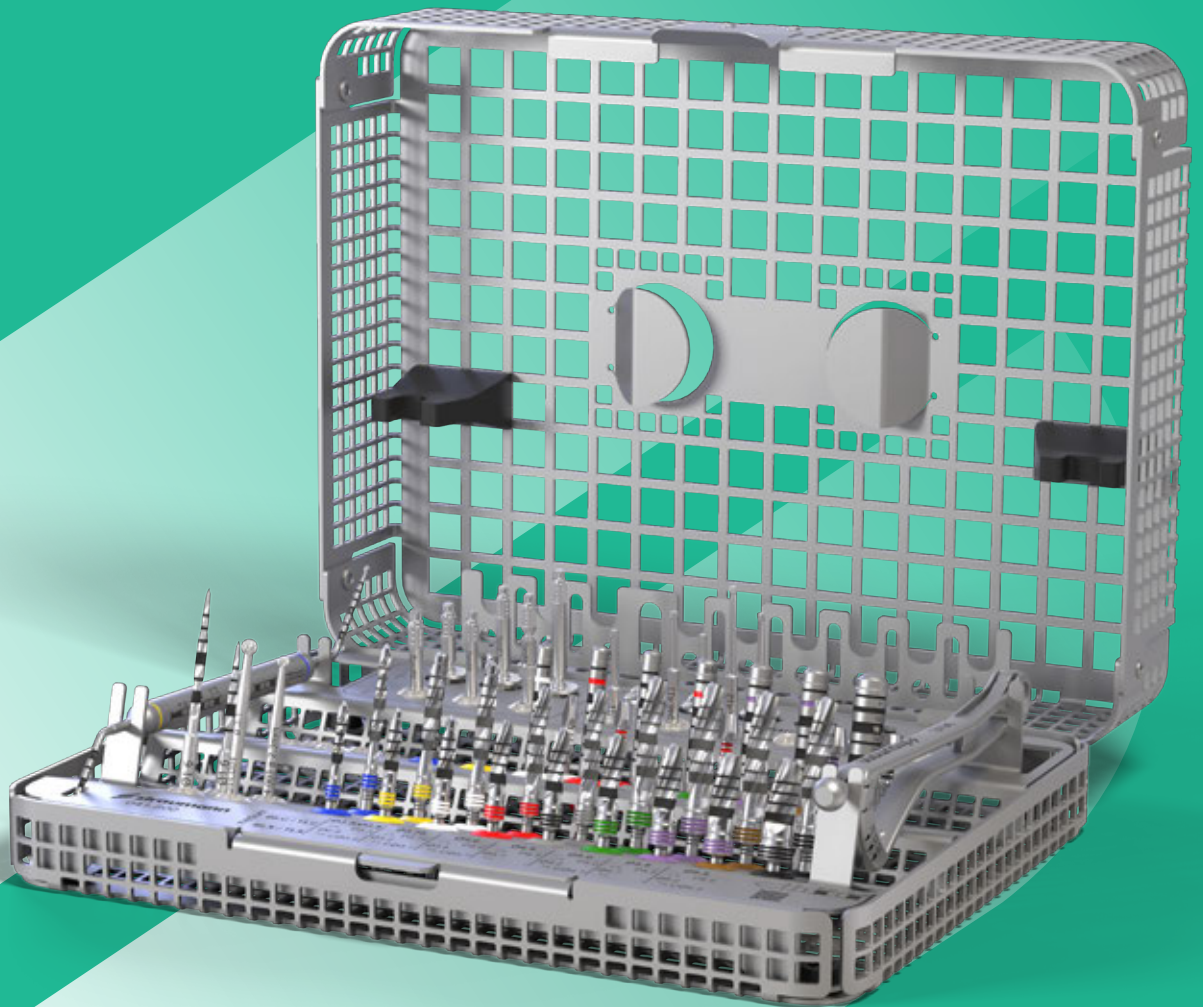

CONTENTS

1. STRAUMANN PROCLEAN™ CASSETTE – UNCOMPROMISED HYGIENE	2
2. STRAUMANN PROCLEAN™ CASSETTE – PRODUCT AT A GLANCE	3
2.1 Tray and base	4
2.2 Lid	6
3. STEP-BY-STEP REPROCESSING	8
3.1 Workflow overview	8
3.2 Chairside	9
3.3 Transport	10
3.4 Pre-treatment	11
3.5 Pre-cleaning (applicable for multi-piece and complex devices)	14
3.6 Inspection	16
3.7 Assembly	17
3.8 Automated cleaning & disinfection	18
3.9 Packaging	20
3.10 Sterilization	21
3.11 Storage	22
4. REPROCESSING VALIDATION STUDY INFORMATION	23
5. FURTHER INFORMATION	23
6. PRODUCT REFERENCE LIST	24
6.1 Straumann iEXCEL™	24
6.2 Straumann iGuide™	26

1. STRAUMANN PROCLEAN™ CASSETTE – UNCOMPROMISED HYGIENE

The Straumann ProClean™ Cassette meets the highest requirements of dental practices and hospitals that demand uncompromised hygiene.

- Outstanding cleaning results and uncompromised hygiene
- Simple workflow due to validated, machine-based reprocessing
- Increased productivity as more time becomes available for clinical activities
- Enhanced staff safety since handling of sharp contaminated instruments is significantly reduced
- Excellent efficiency and ease of use thanks to the fully integrated Straumann surgical workflow navigation

Designed specifically for automated reprocessing, the Straumann ProClean™ Cassette is fully compatible with dental washer-disinfectors to simplify reprocessing workflow and deliver exceptional cleaning results. During the automated reprocessing workflow, the instruments stay in the cassette.

The Straumann ProClean™ cassette is made of high-grade stainless steel to ensure uncompromised hygiene and performance during rigorous machine-based reprocessing. Color-coded silicone grommets ensure instrument retention, offer tactile feedback during handling, and aid in sorting and identification.

2. STRAUMANN PROCLEAN™ CASSETTE – PRODUCT AT A GLANCE

The Straumann ProClean™ Cassette is used as a reusable wash and sterilization cassette system and for the storage of surgical and prosthetic instruments of the Straumann® Dental Implant System.

The Straumann ProClean™ Cassette has been designed for automated cleaning and disinfection – a machine-based process delivered by washer-disinfectors (e.g. Belimed WD290IQ). During the process, the instruments remain in the cassette.

The Straumann ProClean™ Cassette consists of a lid and a base, with the tray securely placed inside the base. The Straumann ProClean™ cassette exists in two sizes: the Straumann ProClean™ iEXCEL™ (179 mm x 137 mm x 49.5 mm) for freehand and the Straumann ProClean™ iGuide™ (225 mm x 162 mm x 49.5 mm) for guided surgery.

To open the cassette, gently pull the opening flap in front by hand while holding the base of the cassette in place. The tray can be removed from the base of the cassette by gently pulling up the tray.

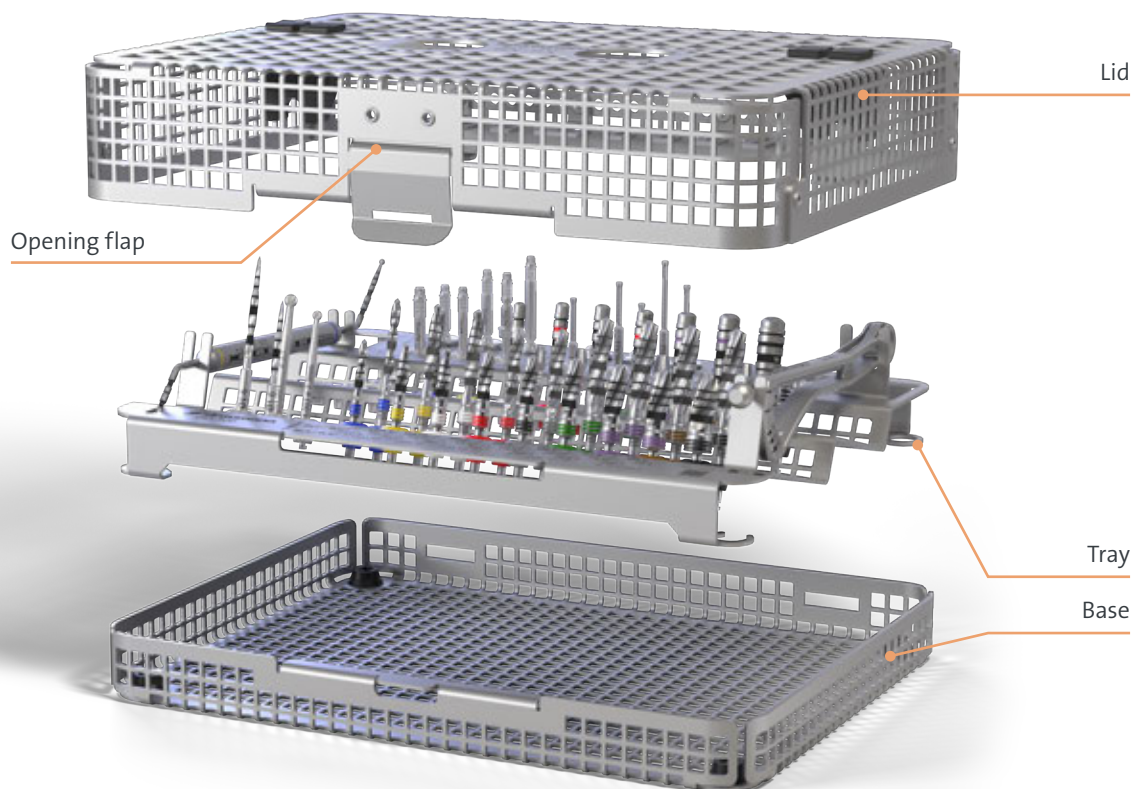

2.1 TRAY AND BASE

To facilitate the surgical procedure and the correct use of the instruments, the Straumann ProClean™ Cassette has instrument pictograms and color-coded grommets to store and recognize all tools to support the surgical workflow. For easy recognition, the article number is marked on the tray for precise identification. The tray can be removed from the base if needed by pulling it up using a slim tool.

All the instruments in the tray are placed in their designated slots according to the surgical workflow.

The Straumann ProClean™ Cassette for Straumann iEXCEL™ is smaller than the Straumann ProClean™ Cassette for Straumann iGuide™. The Straumann iEXCEL™ Cassette has the dimensions of 179x137x50 mm. The Straumann iGuide™ Cassette has the dimensions of 225x162x50 mm.

Straumann iEXCEL™



Straumann iGuide™

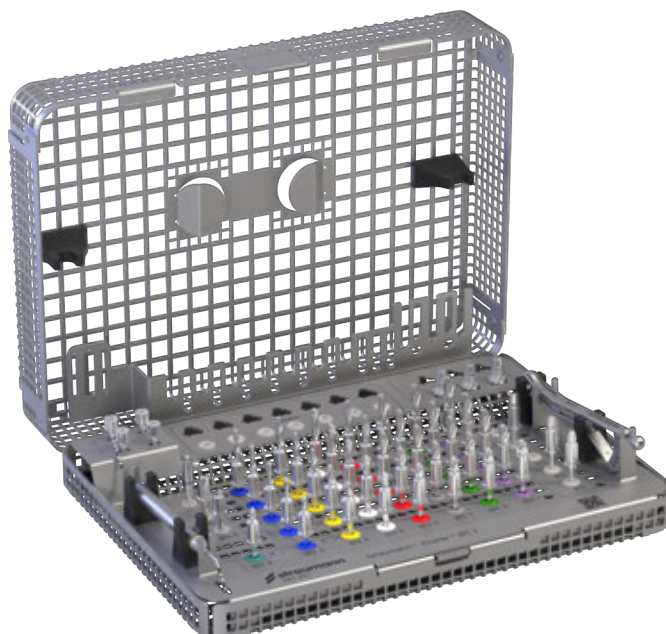

2.1.1 Straumann iEXCEL™ tray

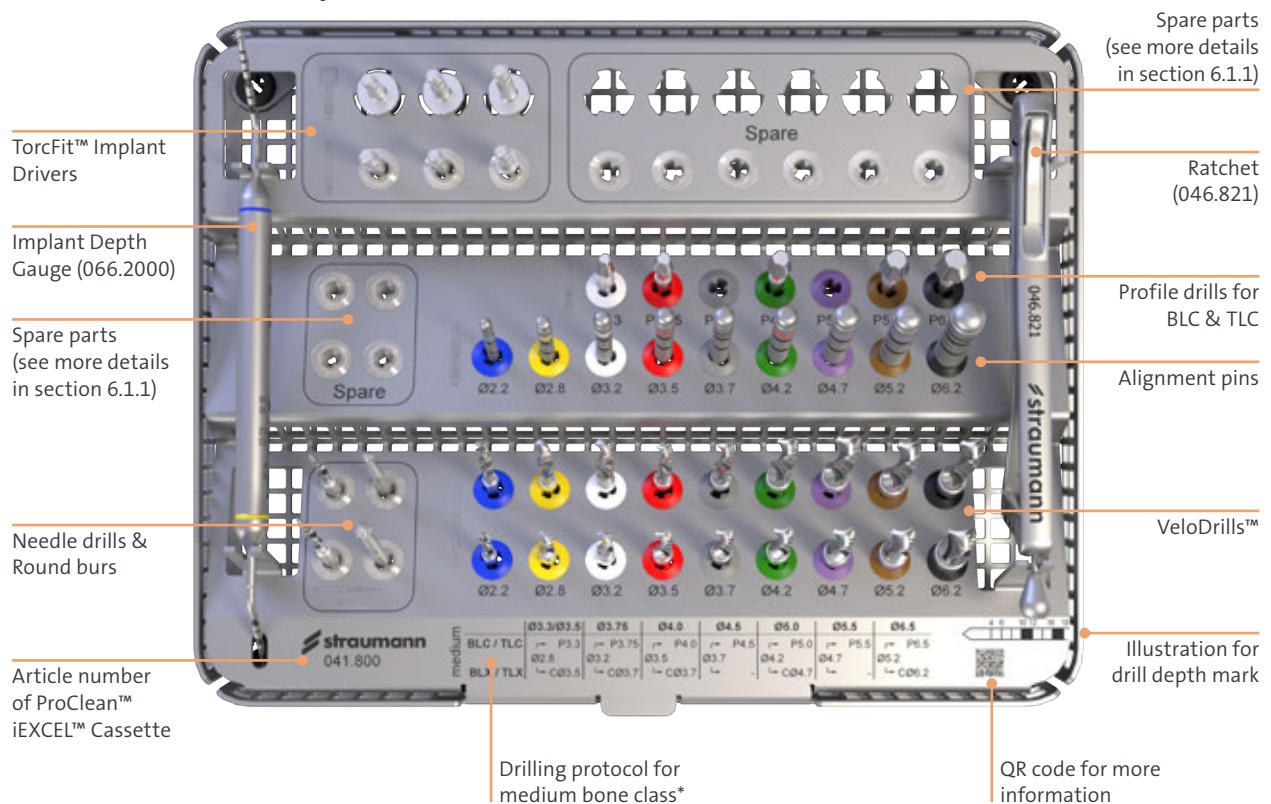

*The full drilling protocols of Straumann iEXCEL™ can be found in the *Straumann iEXCEL™, Basic information* (707743/en) or use the separate drilling protocol sheet (707786/en).

2.1.2 Straumann iGuide™ tray

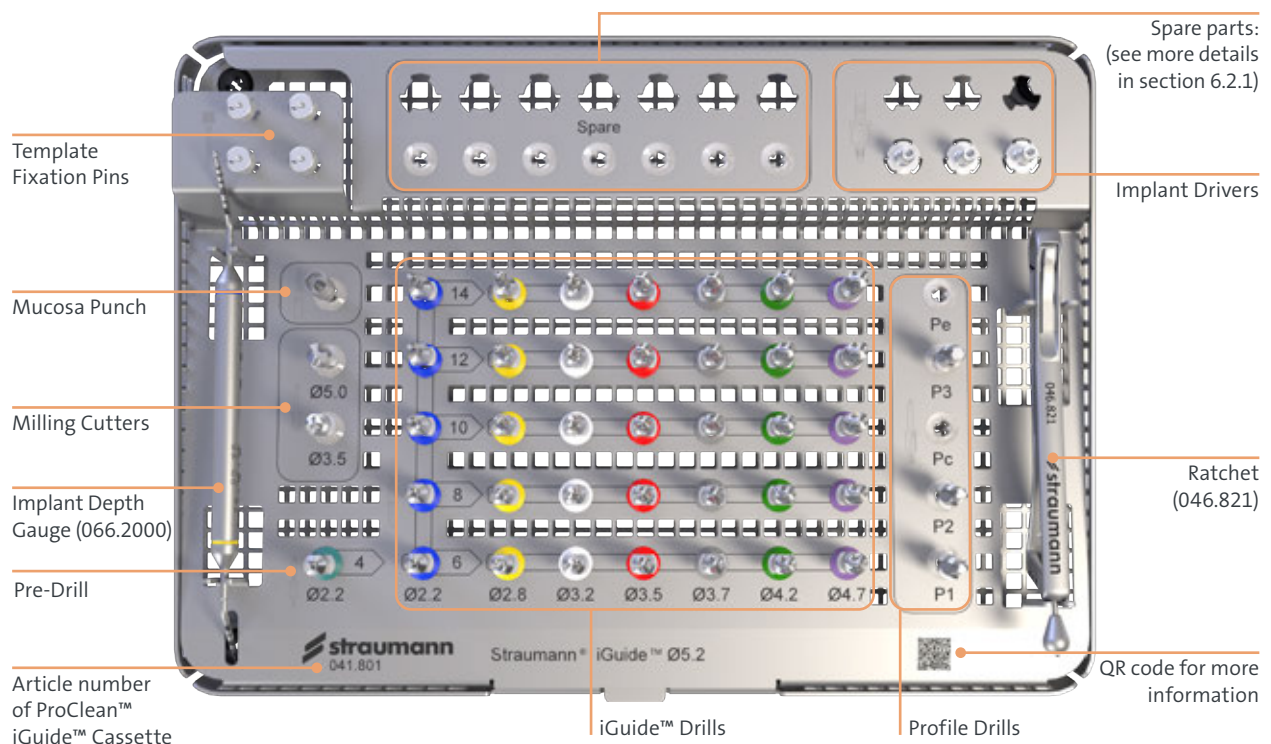

2.2 LID

The lid facilitates safe and secure handling of the cassette. The implant type or the surgical system is clearly laser-marked on the top. It protects:

- Personnel from sharps exposure
- Sterile pouches from drill puncture during sterilization, further handling and storage
- Drills from damage during reprocessing (e.g. drill damage due to their direct contact with the sterilization container)

There are two opening slots on the lid, allowing the Straumann ProClean™ cassette to be easily lifted out of the sterilization container. The cassette can be opened by pulling the spring lock at the front of the cassette.

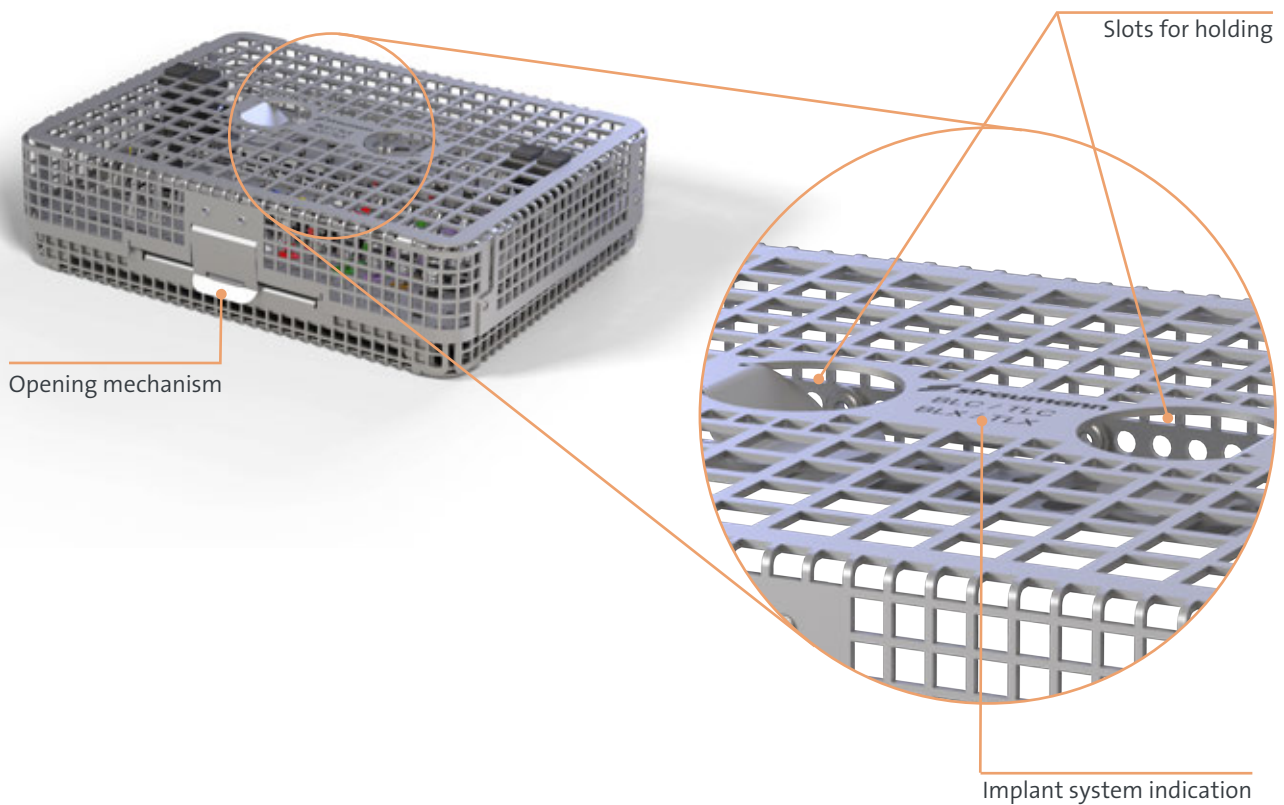

The lid can be completely removed from the base with the tray by pushing the lid backwards when half open. Then the two hooks on the back of the lid will disengage automatically. To close the cassette, insert the two hooks on the lid into the holes on the back of the base, then push the lid down until the spring element clicks into place.

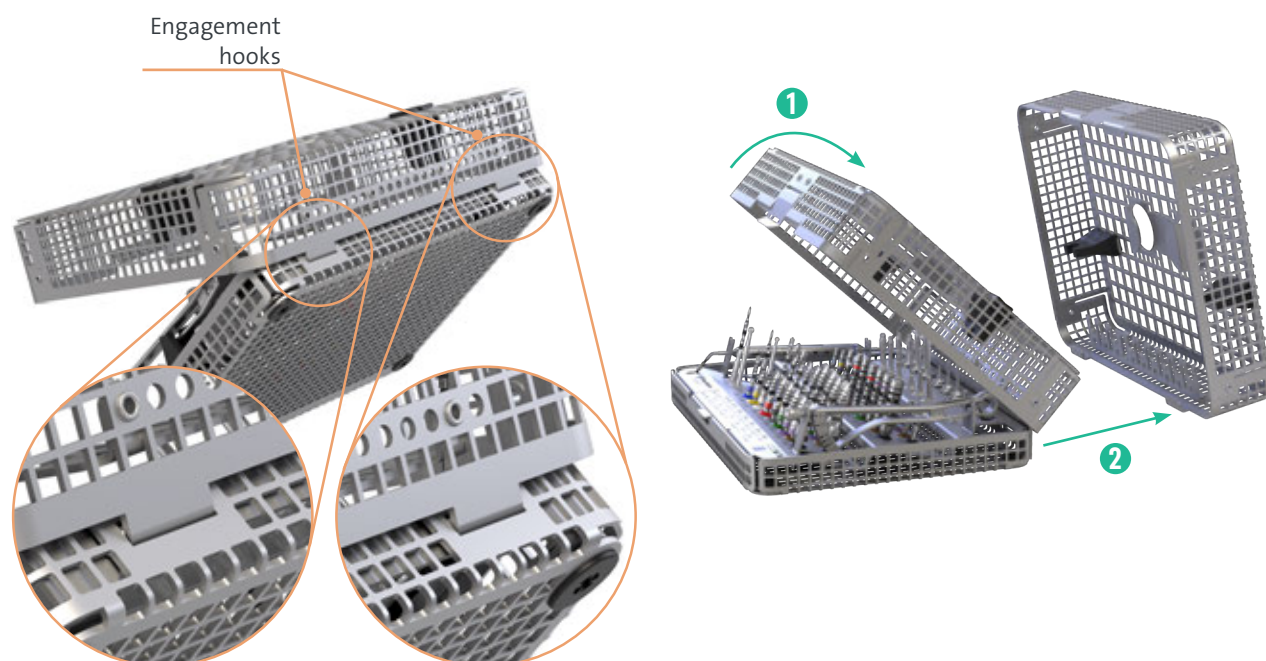

Note: In combination with the iEXCEL™ cassette (Art.No. 041.800) the Demi-sterile container by Ustomed (Art.No. 90-628-065) is compatible. For the iGuide™ cassette (Art.No.: 041.801) the Sterile container by Ustomed (Art.No. 90-626-065) is compatible.

For the US market only: For both the iEXCEL™ cassette (Art.No. 041.800) and the iGuide™ cassette (Art.No. 041.801) the Sterile container by Ustomed (Art.No. 90-618-065) in combination with the filter (90-127-100) is compatible.



3. STEP-BY-STEP REPROCESSING

3.1 WORKFLOW OVERVIEW

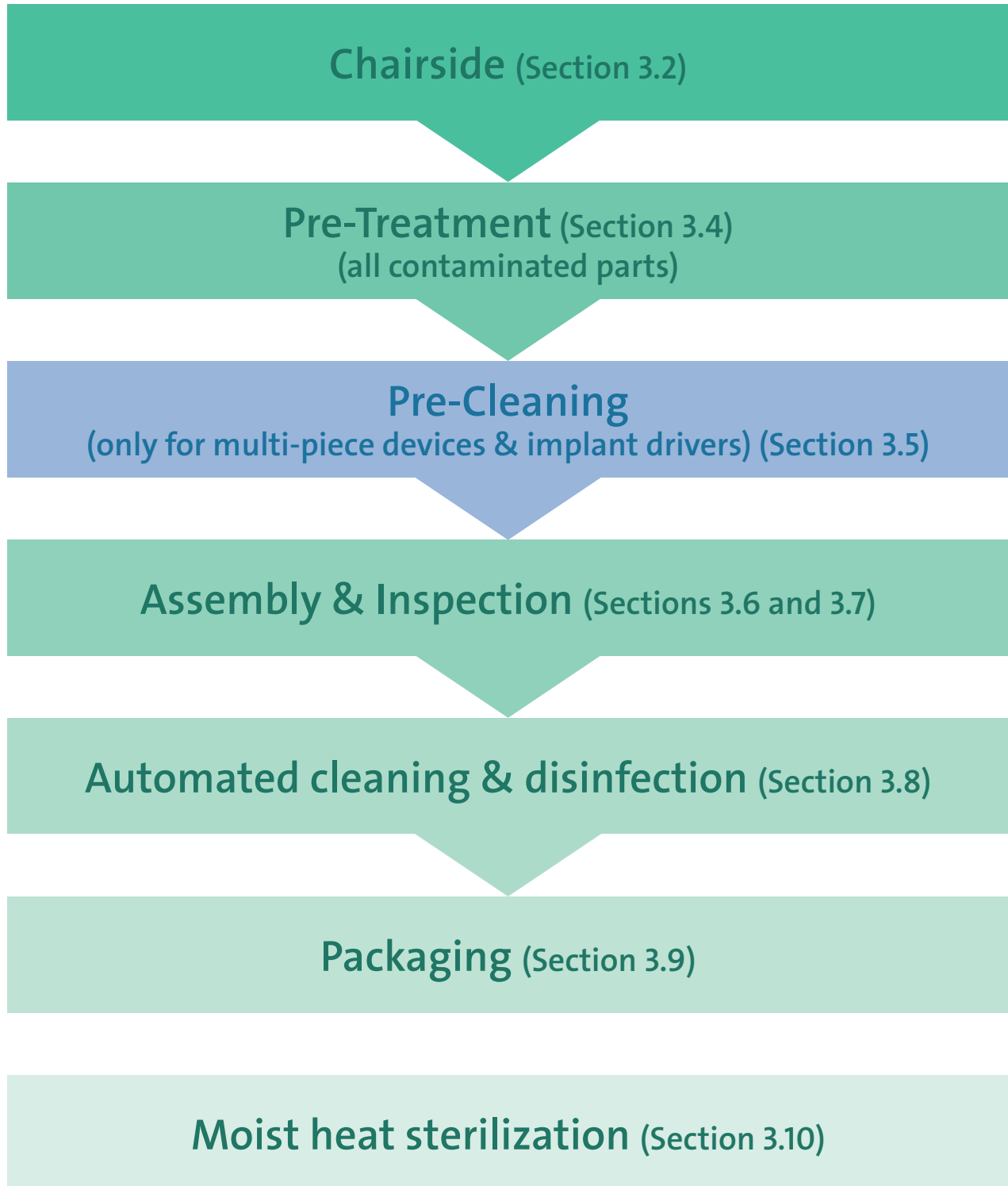

3.2 CHAIRSIDE

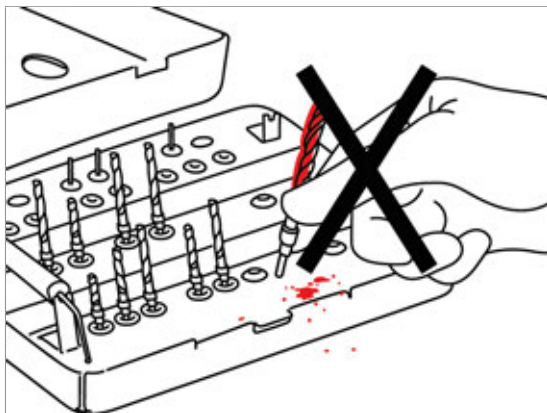

Do not place used or contaminated instruments back in the ProClean™ Cassette during dental surgery.

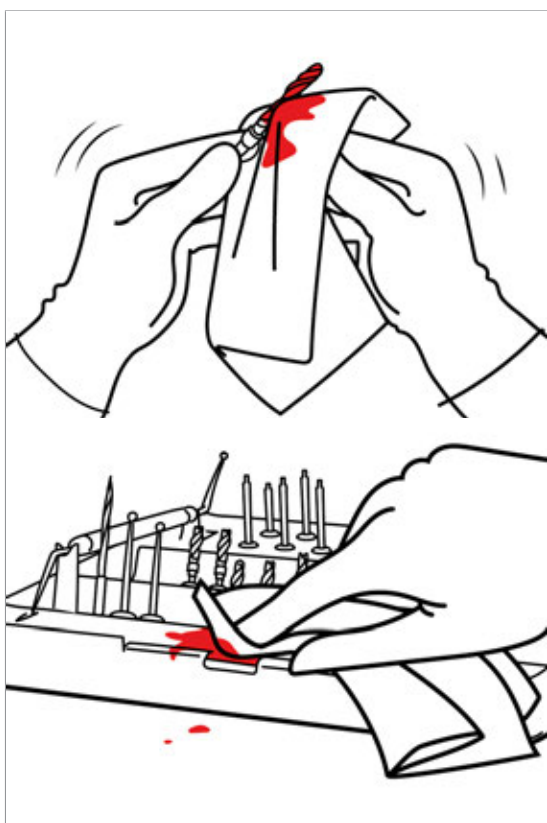

Immediately remove visible contamination from the instruments or cassette.

Keep them moist to prevent drying of blood and debris.

Always process used and contaminated devices as soon as possible after surgery to avoid soil drying.

Note: If applicable, dispose of damaged and blunt instruments.

3.3 TRANSPORT

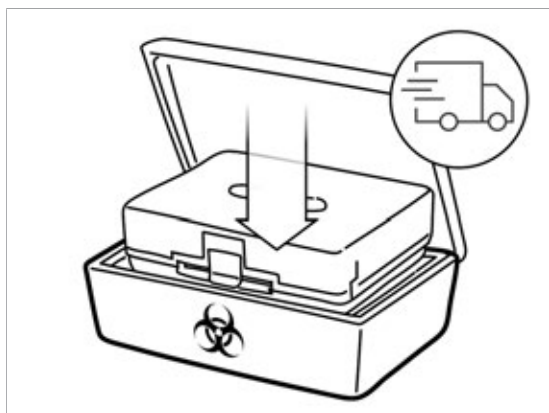

After surgery, store and transport the cassette and instruments in a closed, labelled container to the reprocessing area to protect health-care personnel.

3.4 PRE-TREATMENT

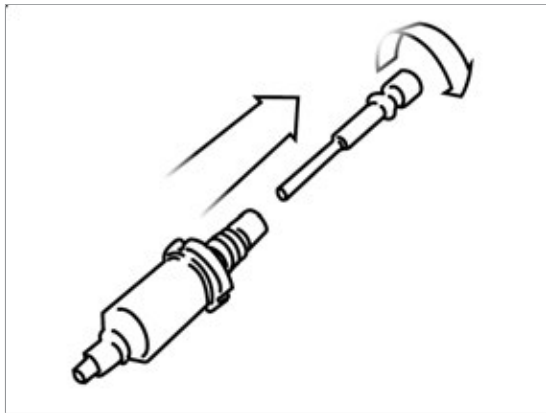

Disassemble multi-piece instruments before pre-treatment.

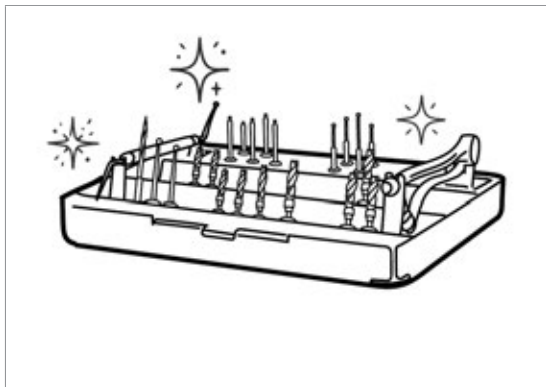

Clean only the instruments that have been used and are contaminated.

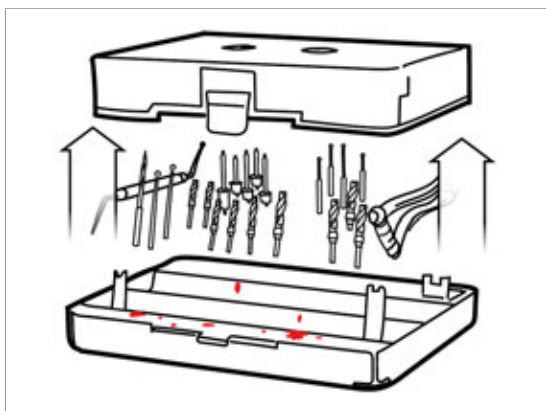

If the cassette is visibly contaminated with surgical soil (e.g., blood), remove all instruments from the cassette.

Then disassemble the cassette by separating the lid from the assembled base/ tray.

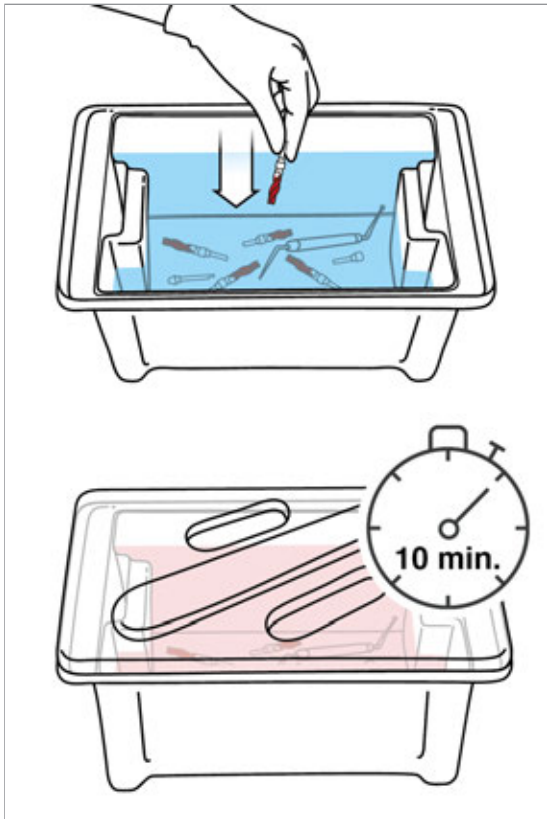

Place all contaminated instruments and cassette parts in a bath of cold, fresh tap water for at least 10 minutes.

Make sure they are completely submerged.

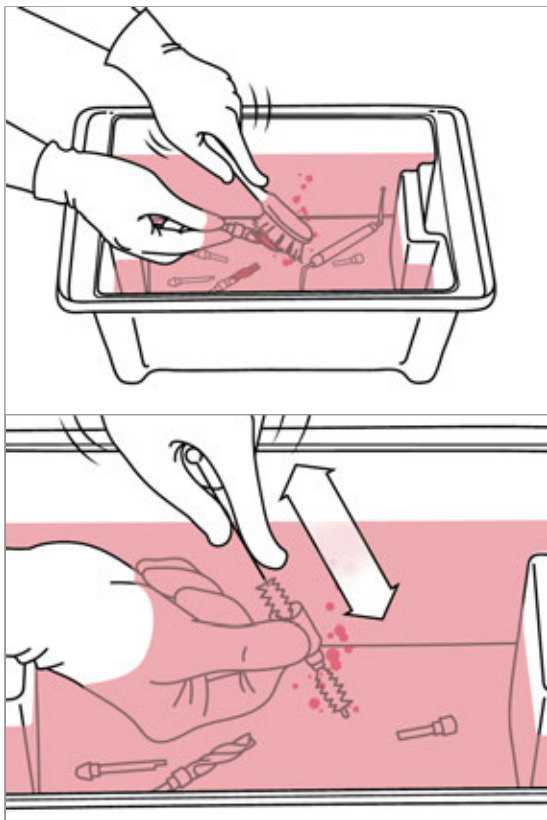

Gently brush the surface of all parts beneath the water surface until all visible soil is removed.

Additionally, brush all inner cavities and lumens beneath the water surface.

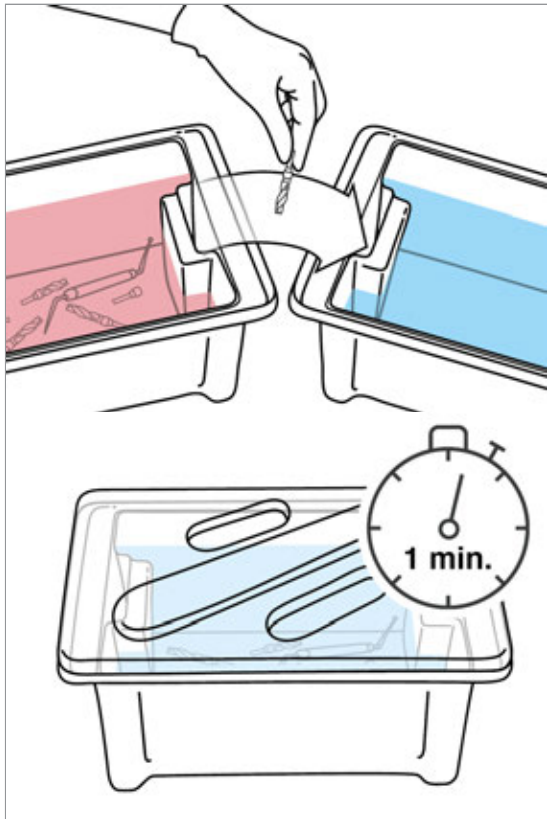

Transfer all devices into a fresh, cold tap water bath for rinsing.



Thoroughly rinse all cavities and internal lumens 5 times with fresh tap water. (e.g., using a 20 ml disposable syringe)

3.5 PRE-CLEANING (APPLICABLE FOR MULTI-PIECE AND COMPLEX DEVICES)

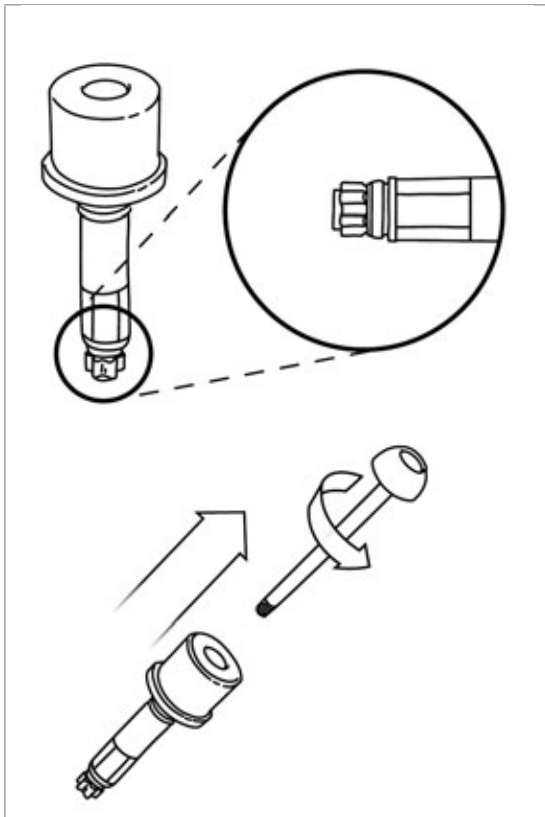

All complex devices with a retention ring and/or consisting of multi-pieces must be manually pre-cleaned, supported by ultrasonication.

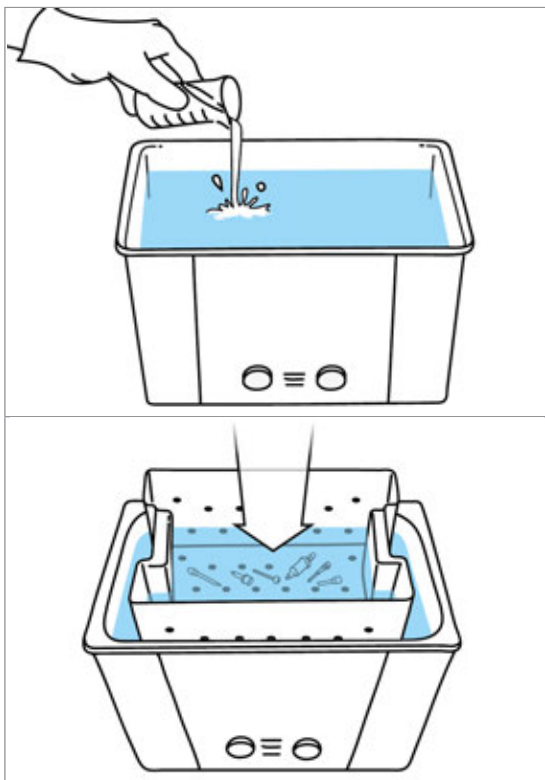

Fill the ultrasonic bath with fresh, cold tap water and prepare the cleaning solution using a suitable detergent (e.g., 0.8% CIDEZYME®).

Note: Never use combination products containing both detergent and disinfectant.

Place all parts in the cleaning solution, ensuring they do not touch each other, are fully submerged, and free of air bubbles.

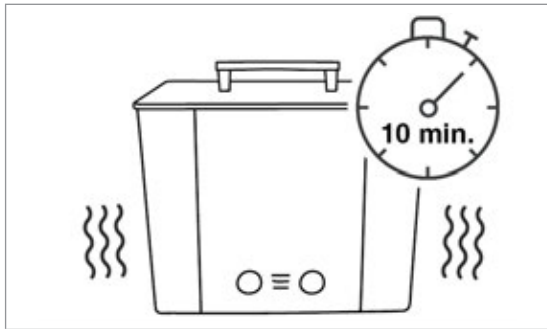

Start the ultrasonic cleaning process and run it for the exposure time specified by the manufacturer (e.g., 10 minutes for CIDEZYME®).



After the cleaning process, transfer all parts from the ultrasonic bath into a fresh, cold water bath for rinsing (at least tap water, preferably deionized).



Thoroughly rinse all cavities and internal lumens three times with fresh water (at least tap water, preferably deionized) using a 20 ml disposable syringe.

3.6 INSPECTION

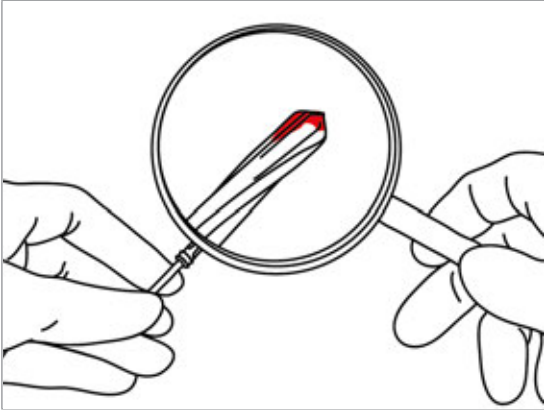

After pre-treatment and pre-cleaning, thoroughly inspect all devices.

Instruments and cassette parts that remain visibly soiled must be cleaned again or replaced.



Devices with visible damage, signs of corrosion, or blunt edges must be discarded and replaced.

Instruments that have exceeded their specified lifetime (e.g., 10 uses for drills) must also be discarded and replaced.

3.7 ASSEMBLY

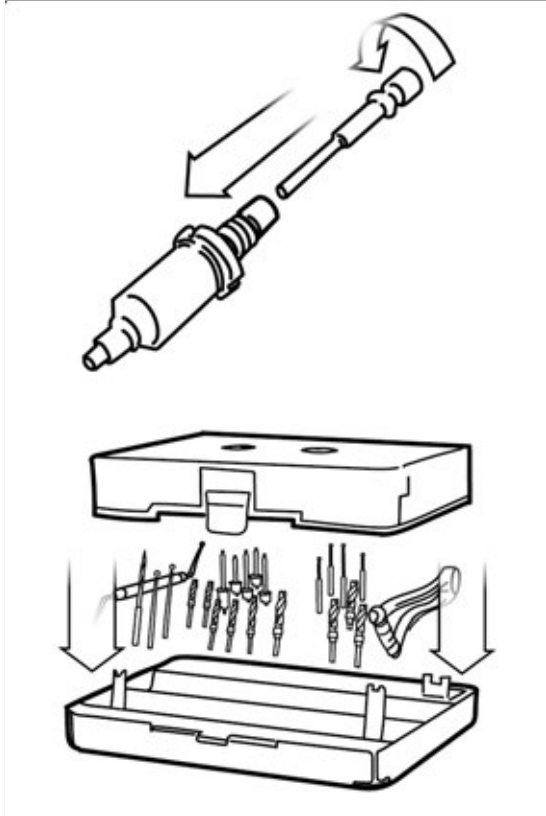

Reassemble all multi-piece instruments and attach the base/tray to the cassette lid.

Place all instruments in their designated positions within the cassette.

Detailed layouts are provided in sections 6.1 and 6.2 or via the QR code on the cassette.

Close the cassette lid.

Note: Ensure instruments are not positioned too low, so they do not protrude from the bottom of the cassette.

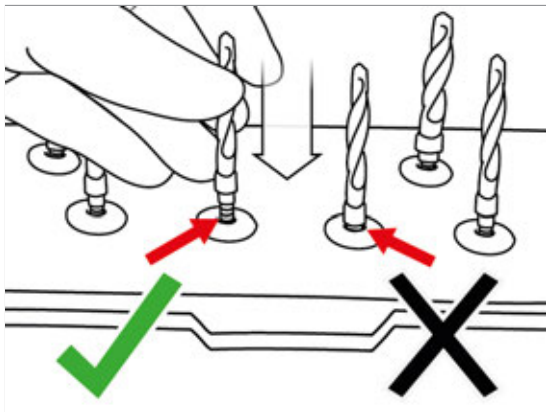

When inserting drills, place them only up to the laser marking line—not deeper—to ensure a proper fit and prevent damage. This also ensures instruments do not protrude below and can be cleaned effectively.

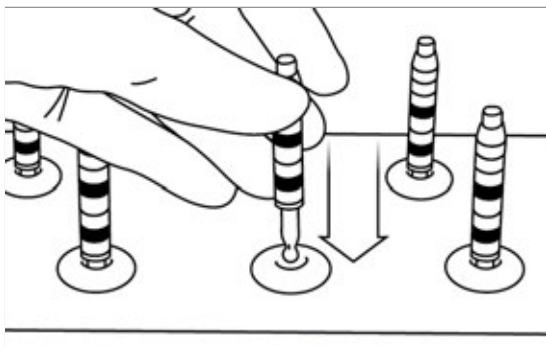

Place all depth gauges with the dental shaft connection ends inserted in the silicone grommets.

3.8 AUTOMATED CLEANING & DISINFECTION



Always follow the manufacturer's instructions for both the washer-disinfector and the cleaning detergent.

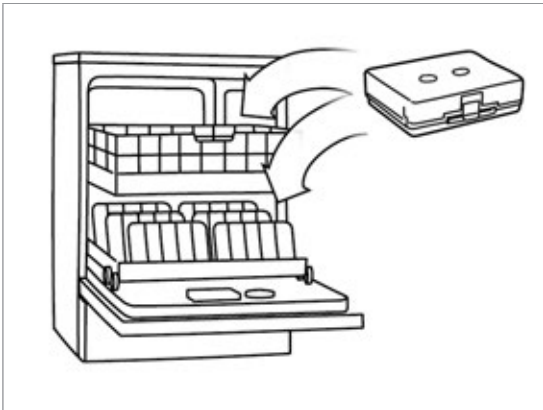

Place the closed, loaded cassette in the washer-disinfector in a flat or angled position.

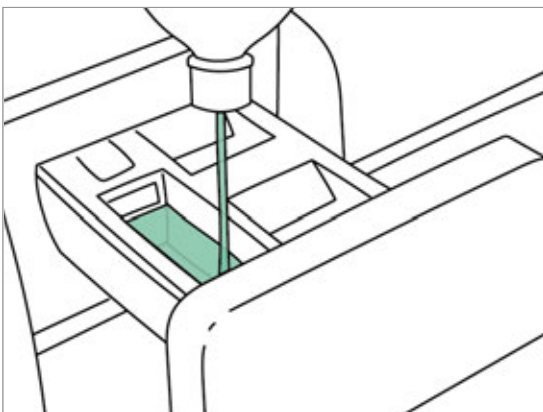

Select an appropriate detergent and follow the manufacturer's instructions. (e.g., 0.5% neodisher® MediClean Forte)

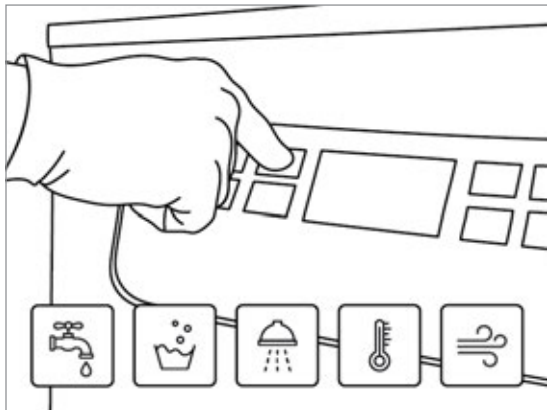

Select a cleaning and thermal disinfection program suitable for medical instruments, following the manufacturer's instructions and country-specific healthcare regulations.

The program should include at least:

1. Pre-cleaning
2. Cleaning
3. Rinsing
4. Thermal Disinfection
5. Drying

Note: For optimal drying, a final drying step at 90°C for at least 30 minutes is highly recommended.

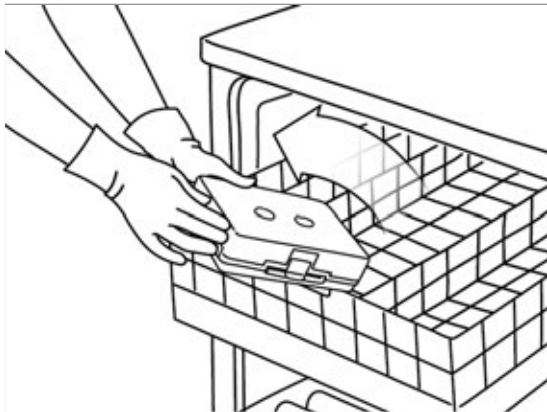

After the program finishes, carefully remove the cassette from the washer-disinfector.

3.9 PACKAGING

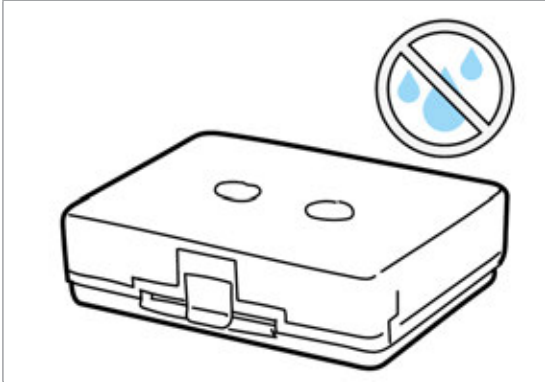

Ensure the cassette and instruments are completely dry before packing for sterilization.



For moist heat sterilization double pouch the cassette in suitable sterilization pouches or use a qualified metal sterilization container.

Affix a sterilization indicator strip with the sterilization date to each package.

OR



3.10 STERILIZATION

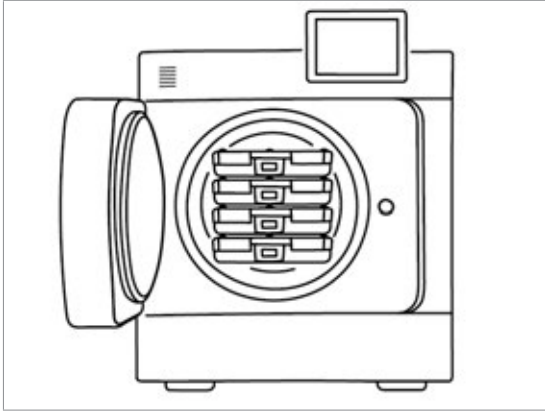

Place the packed cassette in the autoclave, ensuring it does not touch the walls.

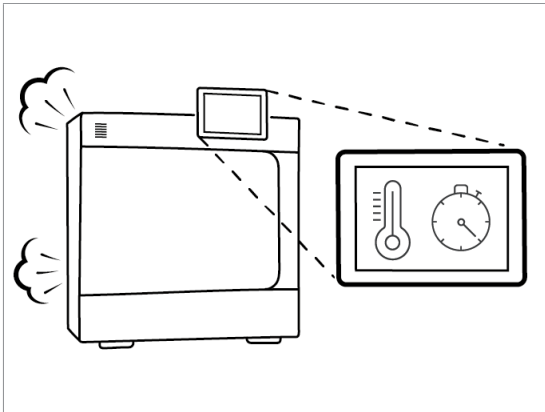

Always use a pre-vacuum moist heat sterilization method. Parameters may vary according to country-specific healthcare regulations.

Straumann recommended minimum parameters for moist heat sterilization:

- **Europe:** 134 °C (273 °F) for 3 minutes, followed by 30 minutes drying
- **United States & Canada:** 132 °C (270 °F) for 4 minutes, followed by 30 minutes drying

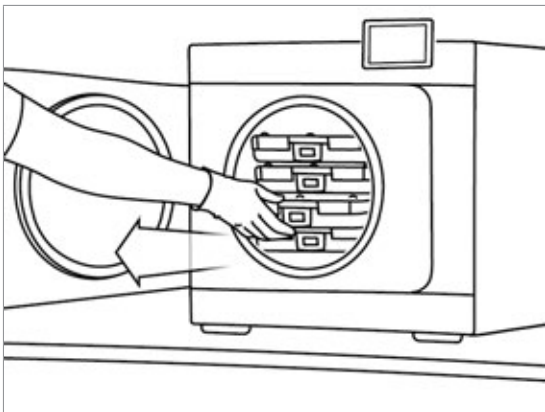

After moist heat sterilization, remove the cassette from the autoclave.

3.11 STORAGE

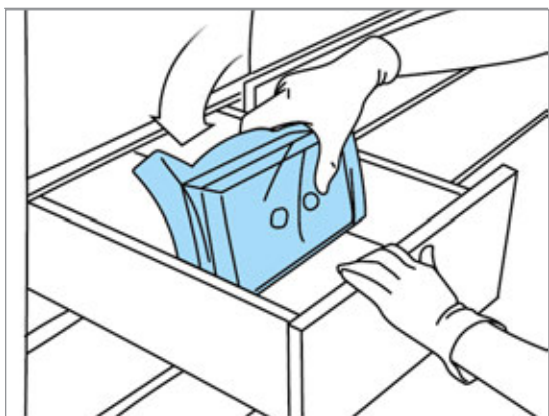

Store the sterile cassette in a dust-free, closed drawer or area.

4. REPROCESSING VALIDATION STUDY INFORMATION

The following devices, materials and machines have been used in the Straumann ProClean™ Cassette validation study:

Ultrasonic bath	Branson ultrasonics CPX series, CPX-952-83-8R/9R (f=40kHz)
Detergent for manual cleaning	CIDEZYME®, 0.8%, Johnson & Johnson
Detergent for automated cleaning and disinfection	neodisher® MediClean Forte, 0.5%, Dr. Weigert
Washer-disinfector	Belimed WD290IQ
Instrument rack	Rack Instruments 4 Level Adaptable (Art.No. 109-2984)

5. FURTHER INFORMATION

For further information (e.g., warnings, cautions, pre-cautions, compatibility), please consult the Instructions for Use *Straumann ProClean™ Cassette, Metal* (708405), *Straumann ProClean™ Cassette, Metal (US version)* (708528) and the brochure *Straumann® Surgical and Prosthetic Instruments – Care and Maintenance* (702000/en).

6. PRODUCT REFERENCE LIST



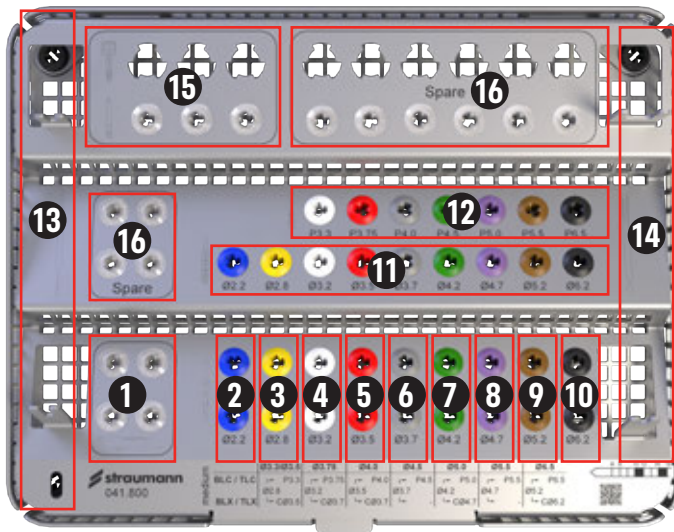



6.1 STRAUMANN iEXCEL™









No.	Art. no.*	Image	Product
	041.800		Straumann ProClean™ Cassette, iEXCEL™ BLC/TLC/BLX/TLX, stainless steel/silicone
1	044.003		Round bur, Ø 2.3 mm, stainless steel
	044.004		Round bur, Ø 3.1 mm, stainless steel
	026.0054		Needle Drill, short, Ø 1.6 mm, L 33 mm, stainless steel
	026.0056		Needle Drill, long, Ø 1.6 mm, L 41 mm, stainless steel
2	066.1301		Pilot VeloDrill™, Ø 2.2 mm, short, stainless steel
	066.1701		Pilot VeloDrill™, Ø 2.2 mm, long, stainless steel
3	066.1302		VeloDrill™, Ø 2.8 mm, short, stainless steel
	066.1702		VeloDrill™, Ø 2.8 mm, long, stainless steel
4	066.1303		VeloDrill™, Ø 3.2 mm, short, stainless steel
	066.1703		VeloDrill™, Ø 3.2 mm, long, stainless steel
5	066.1304		VeloDrill™, Ø 3.5 mm, short, stainless steel
	066.1704		VeloDrill™, Ø 3.5 mm, long, stainless steel
6	066.1305		VeloDrill™, Ø 3.7 mm, short, stainless steel
	066.1705		VeloDrill™, Ø 3.7 mm, long, stainless steel
7	066.1306		VeloDrill™, Ø 4.2 mm, short, stainless steel
	066.1706		VeloDrill™, Ø 4.2 mm, long, stainless steel













No.	Art. no.*	Image	Product
8	066.1307		VeloDrill™, Ø 4.7 mm, short, stainless steel
	066.1707		VeloDrill™, Ø 4.7 mm, long, stainless steel
9	066.1308		VeloDrill™, Ø 5.2 mm, short, stainless steel
	066.1508		VeloDrill™, Ø 5.2 mm, medium, stainless steel
10	066.1309		VeloDrill™, Ø 6.2 mm, short, stainless steel
	066.1509		VeloDrill™, Ø 6.2 mm, medium, stainless steel
11	046.799		Alignment Pin, Ø 2.2 mm, L 27 mm, TAN
	046.800		Depth Gauge, Ø 2.8 mm, L 27 mm, TAN
	046.801		Depth Gauge, Ø 3.2 mm, L 27 mm, TAN
	046.802		Depth Gauge, Ø 3.5 mm, L 27 mm, TAN
	046.803		Depth Gauge, Ø 3.7 mm, L 27 mm, TAN
	046.804		Depth Gauge, Ø 4.2 mm, L 27 mm, TAN
	046.805		Depth Gauge, Ø 4.7 mm, L 27 mm, TAN
	046.806		Depth Gauge, Ø 5.2 mm, L 27 mm, TAN
	046.807		Depth Gauge, Ø 6.2 mm, L 27 mm, TAN











* Not all products are available in all countries.

No.	Art. no.*	Image	Product
12	034.362		BLC/TLC Profile Drill, short, FIBA compatible, Ø 3.3 mm, L 27 mm, stainless steel
	034.363		BLC/TLC Profile Drill, short, FIBA compatible, Ø 3.75 mm, L 26 mm, stainless steel
	034.365		BLC/TLC Profile Drill, short, FIBA compatible, Ø 4.5 mm, L 26 mm, stainless steel
	034.366		BLC/TLC Profile Drill, short, Ø 5.5 mm, L 26 mm, stainless steel
	034.367		BLC/TLC Profile Drill, short, Ø 6.5 mm, L 26 mm, stainless steel
13	066.2000		Implant Depth Gauge, for Ø 2.2/2.8 mm, TAN
14	046.821		Ratchet with Torque Control, stainless steel, Torque markings 0/15/35/50/80 Ncm, L 97 mm

No.	Art. no.*	Image	Product
15	066.4201		TorcFit™ Implant Driver for ratchet, short, L 21 mm, stainless steel
	066.4207		TorcFit™ Implant Driver for ratchet, medium, L 26 mm, stainless steel
	066.4202		TorcFit™ Implant Driver for ratchet, long, L 31 mm, stainless steel
	066.4101		TorcFit™ Implant Driver for handpiece, short, L 21 mm, stainless steel
	066.4107		TorcFit™ Implant Driver for handpiece, medium, L 26 mm, stainless steel
	066.4102		TorcFit™ Implant Driver for handpiece, long, L 31 mm, stainless steel

6.1.1 Optional products (No. 16)

Art. no.*	Image	Product
066.4108		TorcFit™ Implant Driver for handpiece, extra long, L 36 mm, stainless steel
040.563		Drill Extender, L 23 mm, stainless steel
046.400		SCS Screwdriver, for ratchet, x-short, L 15 mm, stainless steel
046.401		SCS Screwdriver, for ratchet, short, L 21 mm, stainless steel
046.402		SCS Screwdriver, for ratchet, long, L 27 mm, stainless steel
046.410		SCS Screwdriver for handpiece, x-short, L 20 mm, stainless steel
046.411		SCS Screwdriver for handpiece, short, L 26 mm, stainless steel
046.412		SCS Screwdriver for handpiece, long, L 32 mm, stainless steel
036.3300		RT Profile Drill, short, for implants Ø 3.75/Ø 4.8 mm, stainless steel
036.3301		RT Profile Drill, long, for implants Ø 3.75/Ø 4.8 mm, stainless steel
036.3302		WT Profile Drill, short, for implants Ø 5.5/Ø 6.5 mm, stainless steel
036.3303		WT Profile Drill, long, for implants Ø 5.5/Ø 6.5 mm, stainless steel
026.0022		BL Bone Profiler 1, Ø 5.2 mm, L 23 mm, stainless steel

Art. no.*	Image	Product
026.0023		BL Bone Profiler 2, Ø 6.6 mm, L 23 mm, stainless steel
026.0024		BL Bone Profiler 3, Ø 6 mm, L 23 mm, stainless steel
044.304		Bone profiler for RN/RT, L 28 mm, stainless steel
044.305		Bone profiler for WN/WT, L 25 mm, stainless steel
066.1501		Pilot VeloDrill™, Ø 2.2 mm, medium, stainless steel
066.1502		VeloDrill™, Ø 2.8 mm, medium, stainless steel
066.1503		VeloDrill™, Ø 3.2 mm, medium, stainless steel
066.1504		VeloDrill™, Ø 3.5 mm, medium, stainless steel
066.1505		VeloDrill™, Ø 3.7 mm, medium, stainless steel
066.1506		VeloDrill™, Ø 4.2 mm, medium, stainless steel
066.1507		VeloDrill™, Ø 4.7 mm, medium, stainless steel



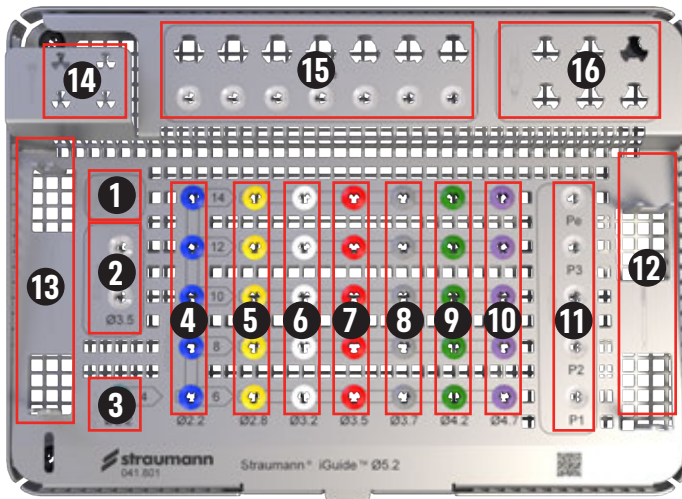



6.2 STRAUMANN iGUIDE™







No.	Art. no.	Image	Product
	041.801		Straumann ProClean™ Cassette, Straumann iGuide™ Ø 5.2 mm, stainless steel/silicone
1	066.5004		iGuide™ Mucosa Punch, T-sleeve Ø 5.2 mm
2	066.5005		iGuide™ Mill. Cutter Ø 5 mm, T-sleeve Ø 5.2 mm
	066.5061		iGuide™ Mill. Cutter Ø 3.5 mm, T-sleeve Ø 5.2 mm
3	066.5062		iGuide™ Drill Ø 2.2, L 4 mm, T-Sleeve Ø 5.2 mm
4	066.5006		iGuide™ Drill Ø 2.2, L 6 mm, T-sleeve Ø 5.2 mm
	066.5007		iGuide™ Drill Ø 2.2, L 8 mm, T-sleeve Ø 5.2 mm
	066.5008		iGuide™ Drill Ø 2.2, L 10 mm, T-sleeve Ø 5.2 mm
	066.5009		iGuide™ Drill Ø 2.2, L 12 mm, T-sleeve Ø 5.2 mm
	066.5010		iGuide™ Drill Ø 2.2, L 14 mm, T-sleeve Ø 5.2 mm
5	066.5013		iGuide™ Drill Ø 2.8, L 6 mm, T-sleeve Ø 5.2 mm
	066.5014		iGuide™ Drill Ø 2.8, L 8 mm, T-sleeve Ø 5.2 mm
	066.5015		iGuide™ Drill Ø 2.8, L 10 mm, T-sleeve Ø 5.2 mm
	066.5016		iGuide™ Drill Ø 2.8, L 12 mm, T-sleeve Ø 5.2 mm
	066.5017		iGuide™ Drill Ø 2.8, L 14 mm, T-sleeve Ø 5.2 mm







No.	Art. no.	Image	Product
	066.5020		iGuide™ Drill Ø 3.2, L 6 mm, T-sleeve Ø 5.2 mm
	066.5021		iGuide™ Drill Ø 3.2, L 8 mm, T-sleeve Ø 5.2 mm
6	066.5022		iGuide™ Drill Ø 3.2, L 10 mm, T-sleeve Ø 5.2 mm
	066.5023		iGuide™ Drill Ø 3.2, L 12 mm, T-sleeve Ø 5.2 mm
	066.5024		iGuide™ Drill Ø 3.2, L 14 mm, T-sleeve Ø 5.2 mm
7	066.5027		iGuide™ Drill Ø 3.5 mm, L 6 mm, T-sleeve Ø 5.2 mm
	066.5028		iGuide™ Drill Ø 3.5 mm, L 8 mm, T-sleeve Ø 5.2 mm
	066.5029		iGuide™ Drill Ø 3.5 mm, L 10 mm, T-sleeve Ø 5.2 mm
	066.5030		iGuide™ Drill Ø 3.5 mm, L 12 mm, T-sleeve Ø 5.2 mm
	066.5031		iGuide™ Drill Ø 3.5 mm, L 14 mm, T-sleeve Ø 5.2 mm
8	066.5034		iGuide™ Drill Ø 3.7 mm, L 6 mm, T-sleeve Ø 5.2 mm
	066.5035		iGuide™ Drill Ø 3.7 mm, L 8 mm, T-sleeve Ø 5.2 mm
	066.5036		iGuide™ Drill Ø 3.7 mm, L 10 mm, T-sleeve Ø 5.2 mm
	066.5037		iGuide™ Drill Ø 3.7 mm, L 12 mm, T-sleeve Ø 5.2 mm
	066.5038		iGuide™ Drill Ø 3.7 mm, L 14 mm, T-sleeve Ø 5.2 mm
9	066.5041		iGuide™ Drill Ø 4.2 mm, L 6 mm, T-sleeve Ø 5.2 mm
	066.5042		iGuide™ Drill Ø 4.2 mm, L 8 mm, T-sleeve Ø 5.2 mm
	066.5043		iGuide™ Drill Ø 4.2 mm, L 10 mm, T-sleeve Ø 5.2 mm
	066.5044		iGuide™ Drill Ø 4.2 mm, L 12 mm, T-sleeve Ø 5.2 mm
	066.5045		iGuide™ Drill Ø 4.2 mm, L 14 mm, T-sleeve Ø 5.2 mm

No.	Art. no.	Image	Product
10	066.5048		iGuide™ Drill Ø 4.7 mm, L 6 mm, T-sleeve Ø 5.2 mm
	066.5049		iGuide™ Drill Ø 4.7 mm, L 8 mm, T-sleeve Ø 5.2 mm
	066.5050		iGuide™ Drill Ø 4.7 mm, L 10 mm, T-sleeve Ø 5.2 mm
	066.5051		iGuide™ Drill Ø 4.7 mm, L 12 mm, T-sleeve Ø 5.2 mm
	066.5052		iGuide™ Drill Ø 4.7 mm, L 14 mm, T-sleeve Ø 5.2 mm
11	066.5055		iGuide™ Prof. Drill P1, T-sleeve Ø 5.2 mm
	066.5056		iGuide™ Prof. Drill P2, T-sleeve Ø 5.2 mm
	066.5057		iGuide™ Prof. Drill P3, T-sleeve Ø 5.2 mm

No.	Art. no.	Image	Product
12	046.821		Ratchet Torque Control, L 97 mm, stainless steel
13	066.2000		Implant Depth Gauge
14	066.5000		iGuide™ Template Fixation Pin, Ø1.5 mm, TAN
15	066.5058		iGuide™ Imp. Driv. BLC/BLX, adap., stop, Ø 5.2 mm
	066.5059		iGuide™ Imp. Driv. TLC/TLX SP, adap., stop, Ø 5.2 mm
	066.5060		iGuide™ Imp. Driv. TLC/TLX S, adap., stop, Ø 5.2 mm

6.2.1 Optional products

Art. no.*	Image	Product
046.400		SCS Screwdriver for Ratchet, extra-short
046.401		SCS Screwdriver for Ratchet, short
046.402		SCS Screwdriver for Ratchet, long
066.5002		iGuide™ Drill, Templ. Fixation Pin, Ø1.5 mm, stainless steel
046.410		SCS Screwdriver for Handpiece, extra-short

Art. no.*	Image	Product
046.411		SCS Screwdriver for Handpiece, short
046.412		SCS Screwdriver for Handpiece, long
046.471		Handpiece adapter, L 26 mm, short
046.472		Handpiece adapter, L 34 mm, long
046.460		Adapter for Ratchet, extra-short, L 11 mm
046.461		Adapter for Ratchet, short, L 18 mm

NOTES

neodisher® MediClean is a registered trademark of Chemische Fabrik Dr. Weigert GmbH & Co. KG, Germany.
CIDEZYME®, is a registered trademark of Johnson & Johnson Corporation, USA.

708404/en/C/02 11/25

International Headquarters

Institut Straumann AG
Peter Merian-Weg 12
CH-4002 Basel, Switzerland
Phone +41 (0)61 965 11 11
Fax +41 (0)61 965 11 01
www.straumann.com

© Institut Straumann AG, 2025. All rights reserved.
Straumann® and/or other trademarks and logos from Straumann® mentioned herein are the trademarks or registered trademarks of Straumann Holding AG and/or its affiliates.

